

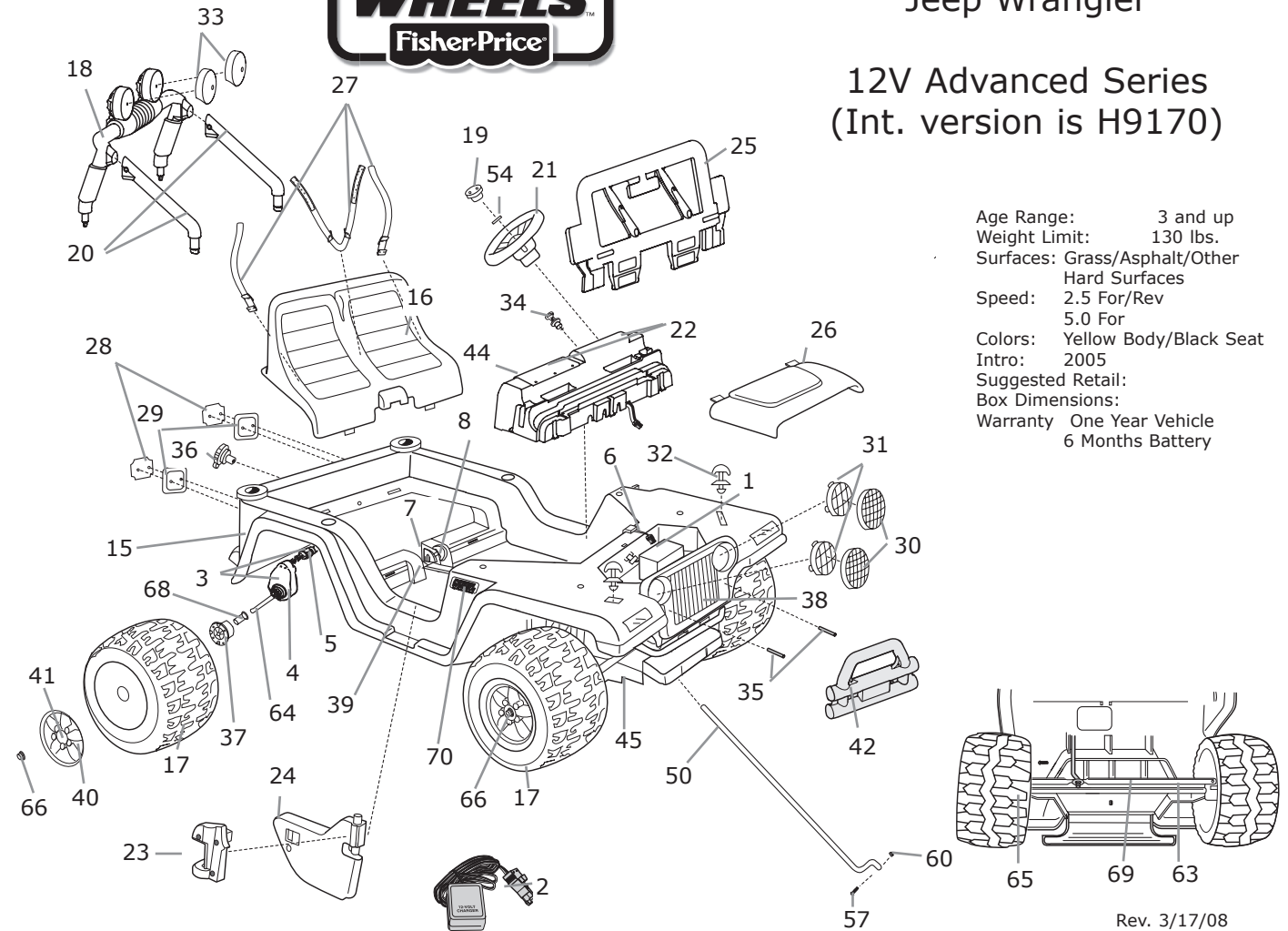

# H4807 Jeep Wrangler

12V Advanced Series  
(Int. version is H9170)



Age Range: 3 and up  
Weight Limit: 130 lbs.  
Surfaces: Grass/Asphalt/Other Hard Surfaces  
Speed: 2.5 For/Rev  
5.0 For  
Colors: Yellow Body/Black Seat  
Intro: 2005  
Suggested Retail:  
Box Dimensions:  
Warranty One Year Vehicle  
6 Months Battery

Rev. 3/17/08

Item No.	Description	Part No.	Qty.	Item No.	Description	Part No.	Qty.	Item No.	Description	Part No.	Qty.				
<b>Working / Electrical Parts</b>															
1.	Single 12V Battery	00801-0638	1	31.	Headlight Lens	74440-2879	2	57.	8 x 5/8 Screw		1				
2.	Single 12V Charger	00801-0972	1	32.	Hood Latch	H4807-9559	2	58.	8 Acorn Lock Nut	N/A	2				
<b>3.</b>	<b>Motor Grbx Assy.</b>	<b>00968-2912</b>	<b>2</b>	33.	Light Cover	H4807-2169	2	59.	(Order Hardware Bag)						
<b>4.</b>	<b>Gearbx W/out Motor</b>	<b>00968-2802</b>	<b>2</b>	34.	Key Assembly	74765-9369	1	60.	8 Lock Nut	N/A	1				
<b>5.</b>	<b>Motor Pin Assy</b>	<b>00968-2702</b>	<b>2</b>	35.	Spacer	74460-2069	2	61.	(Order Hardware Bag)						
<b>6.</b>	<b>Main Harness Assy.</b>	<b>C2390-9799D</b>	<b>1</b>	36.	Gas Cap	75840-2439	1	62.	3/8 Washer		1				
<b>7.</b>	<b>Shifter Harn Assy.</b>	<b>G3740-9100D</b>	<b>1</b>	37.	Driver	74460-2249	2	63.	Steering Linkage Assm.	B7659-9419D	1				
8.	Shifter Assembly	74310-9239	1	38.	Grill	75598-2849	1	64.	Rear Axle	B7659-4529	1				
<b>Plastic / Other Parts</b>															
15.	Body	N/A	1	39.	Channel Cover	B7659-2289	1	65.	Front Axle	B7659-4519	2				
16.	Seat	H4803-2819	1	40.	Hubcap	B7659-2469	4	66.	.437 Cap Nut	0801-0226	4				
17.	Wheel	B7659-2459	4	41.	Hubcap Center	B7659-2679	4	68.	7/16 Round/Axle Bush	74550-2689					
18.	Sport Bar, drilled	B7659-2219	1	42.	Brushguard	B7659-2189	1	69.	Cross Bar	75840-4409					
19.	Steering Wheel Cap	74550-2729	1	<b>44.</b>	<b>**Radio</b>	<b>H4803-9309</b>	<b>1</b>	70.	PW Emblem	0801-1503	2				
20.	Sport Bar Support, drilled	B7659-2379	2	<b>(Consumer Replaceable By Ordering Part 22 Dash w/Radio)</b>											
21.	Steering Wheel	74440-2379	1	<b>Hardware / Metal Parts</b>											
22.	Dash w/Radio	H4807-9259	1	50.	Steering Column	H4803-4409	1	<b>Parts Not Shown</b>							
23.	Door Hinge (Right)	H4807-2129	1	51.	10 x 1/2 Screw	N/A	4	Large Parts Bag	H4807-9269	1					
24.	Door (Left/Right)	3800-7694	2	52.	8 x 1 Screw	N/A	8	Hardware Bag (New Style)	3800-7921	1					
25.	Windshield	B7659-2619	1	(Order Hardware Bag)				Owners Manual	H4807-0920	1					
26.	Hood	3800-7175	1	53.	10 x 1 Screw	N/A	11	Decal Sheet	H4807-0320	1					
27.	Seat Belt Set	74440-5349	1	(Order Hardware Bag)				<b>Switch Control (Shifter-Rock Footswitch (Plunger Type))</b>	<b>00801-0923</b>	<b>1</b>					
28.	Taillight Lens Set	73233-2279	1	54.	5/32 x 1 1/2 Pin	N/A	1	Door Hinge (Left)	H4807-2139	1					
29.	Taillight Housing Set	73233-2759	1	55.	8 x 4 Screw	N/A	2	Footboard Assembly	74020-9839D						
30.	Lens Guard	74526-2339	2	(Order Hardware Bag)				Radio Bezel	H4803-2369	1					
N/A = Not Available															
				56.	8-32 x 1.625 Screw	N/A	2	Battery Retainer	3800-7809	1					
				(Order Hardware Bag)				Radio battery cover	H3427-2459	1					
								(w/screws & washers)							
								10 x 3/4 Screw (New Style)	N/A	4					

**Bold and Underlined parts are to be purchased and installed by Service Centers only. These items may not be sold directly to consumers by Service Centers or Fisher-Price. \*\* Service Centers: Please see Service Bulletin #176 for replacement of FM Radio.**